

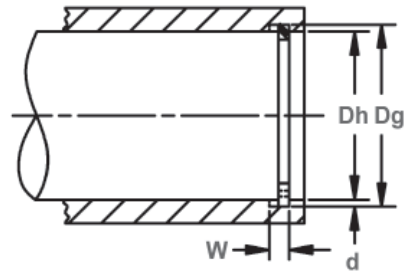

KM Spiral Housing Rings

Internal, Medium Duty
 These 2-turn rings provide 360° groove contact and are designed for applications with medium thrust loads.

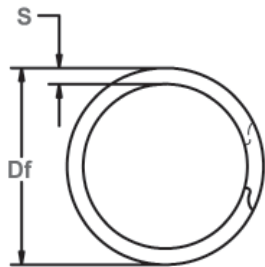

Free Diameter & Ring Measurements

Housing Diameter & Groove Dimensions

| RING NO. | HOUSING DIAMETER (In.) | GROOVE SIZE | | | | | FREE DIAMETER | | RING SIZE THICKNESS | | SECTION | | THRUST LOAD (lbs.) | |
|----------|---------------------------|-------------|--------|-------|--------|-------|---------------|--------|---------------------|--------|---------|--------|-------------------------|---------------------------|
| | | DIAMETER | | WIDTH | | DEPTH | | | | | | | RING Safety factor of 3 | GROOVE Safety factor of 2 |
| | | Dh | Dg | Tol. | W | Tol. | d | Df | Tol. | T | Tol. | S | Tol. | |
| KM-50 | .500 | .526 | | .030 | | .013 | .532 | | .025 | | .045 | | 2000 | 460 |
| KM-51 | .512 | .538 | | .030 | | .013 | .544 | | .025 | | .045 | | 2050 | 470 |
| KM-53 | .531 | .557 | | .030 | | .013 | .564 | | .025 | | .045 | | 2130 | 490 |
| KM-56 | .562 | .588 | | .030 | | .013 | .594 | | .025 | | .045 | | 2250 | 520 |
| KM-59 | .594 | .619 | + .002 | .030 | | .013 | .626 | | .025 | | .045 | | 2380 | 550 |
| KM-62 | .625 | .651 | - .002 | .030 | | .013 | .658 | | .025 | | .045 | | 2500 | 570 |
| KM-65 | .656 | .682 | | .030 | | .013 | .689 | | .025 | | .045 | | 2630 | 600 |
| KM-68 | .687 | .713 | | .030 | | .013 | .720 | | .025 | | .045 | | 2750 | 630 |
| KM-71 | .718 | .744 | | .030 | | .013 | .751 | | .025 | | .045 | | 2870 | 660 |
| KM-75 | .750 | .782 | | .036 | | .016 | .790 | | .031 | | .065 | | 3360 | 850 |
| KM-77 | .777 | .808 | | .036 | | .016 | .817 | + .013 | .031 | | .065 | | 3480 | 880 |
| KM-78 | .781 | .812 | | .036 | + .003 | .016 | .821 | - .000 | .031 | | .065 | | 3500 | 880 |
| KM-81 | .812 | .843 | | .036 | - .000 | .016 | .853 | | .031 | | .065 | | 3640 | 920 |
| KM-84 | .843 | .880 | | .036 | | .019 | .889 | | .031 | | .065 | | 3780 | 1130 |
| KM-86 | .866 | .903 | | .036 | | .019 | .913 | | .031 | | .065 | | 3880 | 1160 |
| KM-87 | .875 | .912 | + .003 | .036 | | .019 | .922 | | .031 | | .065 | | 3920 | 1180 |
| KM-90 | .906 | .943 | - .003 | .036 | | .019 | .949 | | .031 | + .002 | .065 | + .003 | 4060 | 1220 |
| KM-93 | .938 | .975 | | .036 | | .019 | .986 | | .031 | - .002 | .065 | - .005 | 4200 | 1260 |
| KM-96 | .968 | 1.011 | | .042 | | .021 | 1.025 | | .037 | | .075 | | 5180 | 1440 |
| KM-98 | .987 | 1.030 | | .042 | | .021 | 1.041 | | .037 | | .075 | | 5280 | 1470 |
| KM-100 | 1.000 | 1.043 | | .042 | | .021 | 1.054 | | .037 | | .075 | | 5350 | 1480 |
| KM-102 | 1.023 | 1.066 | | .042 | | .021 | 1.078 | | .037 | | .075 | | 5470 | 1520 |
| KM-103 | 1.031 | 1.074 | | .042 | | .021 | 1.084 | | .037 | | .075 | | 5510 | 1530 |
| KM-106 | 1.062 | 1.104 | | .042 | | .021 | 1.117 | | .037 | | .075 | | 5680 | 1580 |
| KM-109 | 1.093 | 1.135 | | .042 | | .021 | 1.147 | | .037 | | .075 | | 5840 | 1620 |
| KM-112 | 1.125 | 1.167 | | .042 | | .021 | 1.180 | | .037 | | .075 | | 6020 | 1670 |
| KM-115 | 1.156 | 1.198 | | .042 | | .021 | 1.210 | | .037 | | .075 | | 6180 | 1720 |
| KM-118 | 1.188 | 1.236 | | .048 | | .024 | 1.249 | | .043 | | .085 | | 7380 | 2020 |
| KM-121 | 1.218 | 1.266 | | .048 | | .024 | 1.278 | | .043 | | .085 | | 7570 | 2070 |
| KM-125 | 1.250 | 1.298 | + .004 | .048 | | .024 | 1.312 | | .043 | | .085 | | 7770 | 2120 |
| KM-128 | 1.281 | 1.329 | - .004 | .048 | | .024 | 1.342 | + .015 | .043 | | .085 | | 7960 | 2170 |
| KM-131 | 1.312 | 1.360 | | .048 | + .004 | .024 | 1.374 | - .000 | .043 | | .085 | | 8150 | 2230 |
| KM-134 | 1.343 | 1.395 | | .048 | - .000 | .026 | 1.408 | | .043 | | .085 | | 8350 | 2470 |
| KM-137 | 1.375 | 1.427 | | .048 | | .026 | 1.442 | | .043 | | .095 | | 8540 | 2530 |
| KM-140 | 1.406 | 1.458 | | .048 | | .026 | 1.472 | | .043 | | .095 | | 8740 | 2580 |
| KM-143 | 1.437 | 1.489 | | .048 | | .026 | 1.504 | | .043 | | .095 | | 8930 | 2640 |
| KM-145 | 1.456 | 1.508 | | .048 | | .026 | 1.523 | | .043 | | .095 | | 9050 | 2680 |
| KM-146 | 1.468 | 1.520 | | .048 | | .026 | 1.535 | | .043 | | .095 | | 9120 | 2700 |
| KM-150 | 1.500 | 1.552 | | .048 | | .026 | 1.567 | | .043 | | .095 | | 9320 | 2760 |

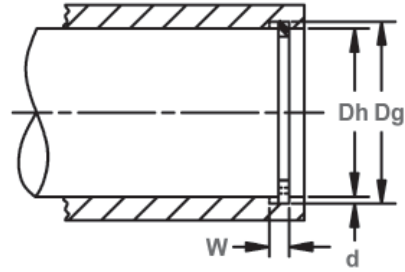
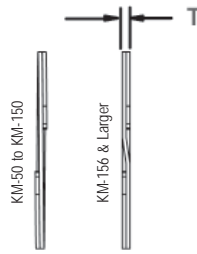
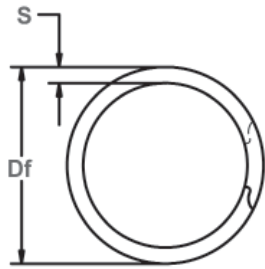

Free Diameter & Ring Measurements

Housing Diameter & Groove Dimensions

| RING NO. | HOUSING DIAMETER (In.) | GROOVE SIZE | | | | | FREE DIAMETER | | | RING SIZE THICKNESS | | SECTION | | THRUST LOAD (lbs.) | |
|----------|------------------------|-------------|-------|-------|-------|-------|---------------|-------|------|---------------------|------|---------|-------|-------------------------|---------------------------|
| | | DIAMETER | | WIDTH | | DEPTH | FREE DIAMETER | | | THICKNESS | | SECTION | | RING Safety factor of 3 | GROOVE Safety factor of 2 |
| | | Dh | Dg | Tol. | W | Tol. | d | Df | Tol. | T | Tol. | S | Tol. | | |
| KM-156 | 1.562 | 1.617 | | .056 | | .028 | 1.634 | | .049 | | .108 | | 10100 | 3090 | |
| KM-157 | 1.574 | 1.633 | | .056 | | .030 | 1.649 | | .049 | | .108 | | 10180 | 3340 | |
| KM-162 | 1.625 | 1.684 | | .056 | | .030 | 1.701 | | .049 | | .108 | | 10510 | 3350 | |
| KM-165 | 1.653 | 1.712 | | .056 | | .030 | 1.730 | | .049 | | .108 | | 10690 | 3510 | |
| KM-168 | 1.687 | 1.750 | +.005 | .056 | | .031 | 1.768 | +.020 | .049 | | .118 | | 10910 | 3700 | |
| KM-175 | 1.750 | 1.813 | -.005 | .056 | | .031 | 1.834 | -.000 | .049 | | .118 | | 11310 | 3840 | |
| KM-181 | 1.813 | 1.875 | | .056 | | .031 | 1.894 | | .049 | | .118 | | 11720 | 3970 | |
| KM-185 | 1.850 | 1.917 | | .056 | | .034 | 1.937 | | .049 | | .118 | | 11960 | 4450 | |
| KM-187 | 1.875 | 1.942 | | .056 | | .034 | 1.960 | | .049 | | .118 | | 12120 | 4510 | |
| KM-193 | 1.938 | 2.005 | | .056 | | .034 | 2.025 | | .049 | | .118 | | 12530 | 4660 | |
| KM-200 | 2.000 | 2.071 | | .056 | | .035 | 2.091 | | .049 | | .128 | | 12930 | 4950 | |
| KM-204 | 2.047 | 2.118 | | .056 | | .035 | 2.138 | | .049 | | .128 | | 18240 | 5060 | |
| KM-206 | 2.062 | 2.132 | | .056 | | .035 | 2.154 | | .049 | | .128 | +.003 | 13330 | 5100 | |
| KM-212 | 2.125 | 2.195 | | .056 | | .035 | 2.217 | | .049 | | .128 | -.005 | 13740 | 5260 | |
| KM-216 | 2.165 | 2.239 | | .056 | +.004 | .037 | 2.260 | | .049 | | .138 | | 14000 | 5660 | |
| KM-218 | 2.188 | 2.262 | | .056 | -.000 | .037 | 2.284 | | .049 | | .138 | | 14150 | 5720 | |
| KM-225 | 2.250 | 2.324 | | .056 | | .037 | 2.347 | | .049 | | .138 | | 14550 | 5890 | |
| KM-231 | 2.312 | 2.390 | | .056 | | .039 | 2.413 | | .049 | | .138 | | 14950 | 6370 | |
| KM-237 | 2.375 | 2.453 | | .056 | | .039 | 2.476 | | .049 | | .138 | | 15360 | 6550 | |
| KM-243 | 2.437 | 2.519 | | .056 | | .041 | 2.543 | | .049 | | .148 | | 15760 | 7060 | |
| KM-244 | 2.440 | 2.522 | | .056 | | .041 | 2.546 | | .049 | | .148 | | 15780 | 7070 | |
| KM-250 | 2.500 | 2.582 | | .056 | | .041 | 2.606 | +.025 | .049 | +.003 | .148 | | 16160 | 7250 | |
| KM-253 | 2.531 | 2.617 | | .056 | | .043 | 2.641 | -.000 | .049 | -.003 | .148 | | 16360 | 7690 | |
| KM-256 | 2.562 | 2.648 | | .056 | | .043 | 2.673 | | .049 | | .148 | | 16560 | 7790 | |
| KM-262 | 2.625 | 2.711 | | .056 | | .043 | 2.736 | | .049 | | .148 | | 16970 | 7980 | |
| KM-267 | 2.677 | 2.767 | +.006 | .056 | | .045 | 2.789 | | .049 | | .158 | | 17310 | 8520 | |
| KM-268 | 2.688 | 2.778 | -.006 | .056 | | .045 | 2.803 | | .049 | | .158 | | 17380 | 8550 | |
| KM-275 | 2.750 | 2.841 | | .056 | | .045 | 2.865 | | .049 | | .158 | | 17780 | 8750 | |
| KM-281 | 2.813 | 2.903 | | .056 | | .045 | 2.929 | | .049 | | .158 | | 18190 | 8950 | |
| KM-283 | 2.834 | 2.928 | | .056 | | .047 | 2.954 | | .049 | | .168 | | 18320 | 9520 | |
| KM-287 | 2.875 | 2.969 | | .056 | | .047 | 2.995 | | .049 | | .168 | | 18590 | 9550 | |
| KM-293 | 2.937 | 3.031 | | .056 | | .047 | 3.058 | | .049 | | .168 | | 18990 | 9760 | |
| KM-295 | 2.952 | 3.046 | | .056 | | .047 | 3.073 | | .049 | | .168 | | 19090 | 9810 | |
| KM-300 | 3.000 | 3.096 | | .068 | | .048 | 3.122 | | .061 | | .168 | | 24150 | 10180 | |
| KM-306 | 3.062 | 3.158 | | .068 | | .048 | 3.186 | | .061 | | .168 | +.004 | 24650 | 10390 | |
| KM-312 | 3.125 | 3.223 | | .068 | | .048 | 3.251 | | .061 | | .178 | -.006 | 25150 | 10600 | |
| KM-314 | 3.149 | 3.247 | | .068 | +.005 | .048 | 3.276 | | .061 | | .178 | | 25350 | 10680 | |
| KM-318 | 3.187 | 3.283 | | .068 | -.000 | .048 | 3.311 | +.030 | .061 | | .178 | | 25650 | 10810 | |
| KM-325 | 3.250 | 3.350 | | .068 | | .050 | 3.379 | -.000 | .061 | | .178 | | 26160 | 11490 | |
| KM-331 | 3.312 | 3.416 | | .068 | | .052 | 3.446 | | .061 | | .188 | | 26660 | 12170 | |
| KM-334 | 3.346 | 3.450 | | .068 | | .052 | 3.479 | | .061 | | .188 | | 26930 | 12300 | |
| KM-337 | 3.375 | 3.479 | | .068 | | .052 | 3.509 | | .061 | | .188 | | 27170 | 12410 | |



KM Spiral Housing Rings

Internal, Medium Duty
 These 2-turn rings provide 360° groove contact and are designed for applications with medium thrust loads.

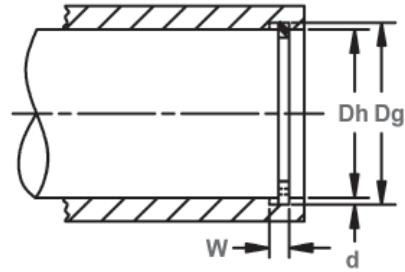
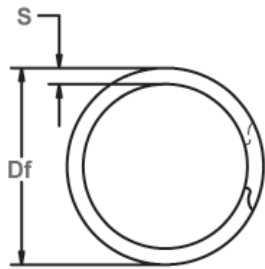

Free Diameter & Ring Measurements

Housing Diameter & Groove Dimensions

| RING NO. | HOUSING DIAMETER | | GROOVE SIZE | | | | FREE DIAMETER | | | RING SIZE THICKNESS | | SECTION | | THRUST LOAD (lbs.) | |
|----------|------------------|-------|-------------|------|--------|-------|---------------|--------|-----------|---------------------|---------|---------|-------------------------|---------------------------|--|
| | Dh (In.) | Dg | DIAMETER | | WIDTH | DEPTH | DIAMETER | | THICKNESS | | SECTION | | RING Safety factor of 3 | GROOVE Safety factor of 2 | |
| | | Tol. | W | Tol. | d | Df | Tol. | T | Tol. | S | Tol. | | | | |
| KM-343 | 3.437 | 3.543 | | .068 | | .053 | 3.574 | | .061 | | .188 | | 27660 | 12880 | |
| KM-350 | 3.500 | 3.606 | | .068 | | .053 | 3.636 | | .061 | | .188 | | 28170 | 13110 | |
| KM-354 | 3.543 | 3.653 | | .068 | | .055 | 3.684 | | .061 | | .198 | | 28520 | 13770 | |
| KM-356 | 3.562 | 3.672 | | .068 | | .055 | 3.703 | | .061 | | .198 | | 28670 | 13850 | |
| KM-362 | 3.625 | 3.737 | | .068 | | .056 | 3.769 | | .061 | | .198 | | 29180 | 14350 | |
| KM-368 | 3.687 | 3.799 | | .068 | | .056 | 3.832 | + .030 | .061 | | .198 | | 29680 | 14600 | |
| KM-374 | 3.740 | 3.852 | | .068 | | .056 | 3.885 | - .000 | .061 | | .198 | | 30100 | 14800 | |
| KM-375 | 3.750 | 3.862 | | .068 | | .056 | 3.894 | | .061 | + .003 | .198 | | 30180 | 14840 | |
| KM-381 | 3.812 | 3.930 | | .068 | | .059 | 3.963 | | .061 | - .003 | .208 | | 30680 | 15900 | |
| KM-387 | 3.875 | 3.993 | | .068 | | .059 | 4.025 | | .061 | | .208 | | 31190 | 16160 | |
| KM-393 | 3.938 | 4.056 | | .068 | | .059 | 4.089 | | .061 | | .208 | | 31700 | 16420 | |
| KM-400 | 4.000 | 4.124 | | .068 | | .062 | 4.157 | | .061 | | .218 | | 32200 | 17530 | |
| KM-406 | 4.063 | 4.187 | | .068 | | .062 | 4.222 | | .061 | | .218 | | 32700 | 17810 | |
| KM-412 | 4.125 | 4.249 | + .006 | .068 | | .062 | 4.284 | | .061 | | .218 | | 33200 | 18080 | |
| KM-418 | 4.188 | 4.311 | - .006 | .068 | + .005 | .062 | 4.347 | | .061 | | .218 | | 33710 | 18350 | |
| KM-425 | 4.250 | 4.380 | | .068 | - .000 | .065 | 4.416 | | .061 | | .228 | | 34210 | 19530 | |
| KM-431 | 4.312 | 4.442 | | .068 | | .065 | 4.479 | | .061 | | .228 | | 34710 | 19810 | |
| KM-433 | 4.330 | 4.460 | | .068 | | .065 | 4.497 | | .061 | | .228 | + .004 | 34850 | 19900 | |
| KM-437 | 4.375 | 4.505 | | .068 | | .065 | 4.543 | | .061 | | .228 | - .006 | 35210 | 20100 | |
| KM-443 | 4.437 | 4.573 | | .068 | | .068 | 4.611 | | .061 | | .238 | | 35710 | 21330 | |
| KM-450 | 4.500 | 4.636 | | .068 | | .068 | 4.674 | | .061 | | .238 | | 36220 | 21630 | |
| KM-452 | 4.527 | 4.663 | | .068 | | .068 | 4.701 | | .061 | | .238 | | 36440 | 21760 | |
| KM-456 | 4.562 | 4.698 | | .068 | | .068 | 4.737 | + .035 | .061 | | .238 | | 36720 | 21930 | |
| KM-462 | 4.625 | 4.765 | | .079 | | .070 | 4.803 | - .000 | .072 | | .250 | | 43940 | 22890 | |
| KM-468 | 4.687 | 4.827 | | .079 | | .070 | 4.867 | | .072 | | .250 | | 44530 | 23190 | |
| KM-472 | 4.724 | 4.864 | | .079 | | .070 | 4.903 | | .072 | | .250 | | 44880 | 23370 | |
| KM-475 | 4.750 | 4.890 | | .079 | | .070 | 4.930 | | .072 | | .250 | | 45130 | 23500 | |
| KM-481 | 4.812 | 4.952 | | .079 | | .070 | 4.993 | | .072 | | .250 | | 45720 | 23810 | |
| KM-487 | 4.875 | 5.015 | | .079 | | .070 | 5.055 | | .072 | | .250 | | 46310 | 24120 | |
| KM-492 | 4.921 | 5.061 | | .079 | | .070 | 5.102 | | .072 | | .250 | | 46750 | 24350 | |
| KM-493 | 4.937 | 5.081 | | .079 | | .072 | 5.122 | | .072 | + .004 | .250 | | 46900 | 25130 | |
| KM-500 | 5.000 | 5.144 | | .079 | | .072 | 5.185 | | .072 | - .004 | .250 | | 47500 | 25450 | |
| KM-511 | 5.118 | 5.262 | | .079 | | .072 | 5.304 | | .072 | | .250 | | 48620 | 26050 | |
| KM-512 | 5.125 | 5.269 | | .079 | | .072 | 5.311 | | .072 | | .250 | | 48690 | 26100 | |
| KM-525 | 5.250 | 5.393 | | .079 | | .072 | 5.436 | | .072 | | .250 | | 49880 | 26720 | |
| KM-537 | 5.375 | 5.522 | | .079 | | .074 | 5.566 | | .072 | | .250 | | 51060 | 28120 | |
| KM-550 | 5.500 | 5.647 | + .007 | .079 | | .074 | 5.693 | + .045 | .072 | | .250 | | 52250 | 28770 | |
| KM-551 | 5.511 | 5.658 | - .007 | .079 | | .074 | 5.703 | - .000 | .072 | | .250 | | 52360 | 28830 | |
| KM-562 | 5.625 | 5.772 | | .079 | | .074 | 5.818 | | .072 | | .250 | | 53440 | 29400 | |
| KM-570 | 5.708 | 5.861 | | .079 | | .077 | 5.909 | | .072 | | .250 | | 54230 | 31070 | |
| KM-575 | 5.750 | 5.903 | | .079 | | .077 | 5.950 | | .072 | | .250 | | 54630 | 31300 | |



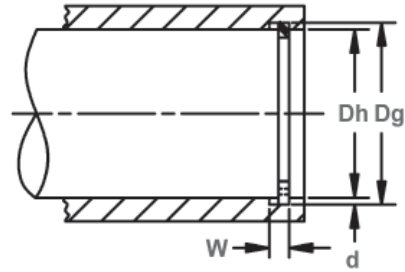
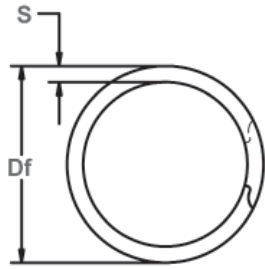

Free Diameter & Ring Measurements

Housing Diameter & Groove Dimensions

| RING NO. | HOUSING DIAMETER (In.) | GROOVE SIZE | | | | | RING SIZE | | | | THRUST LOAD (lbs.) | | | |
|----------|---------------------------|-------------|-------|-------|-------|-------|---------------|-------|-----------|-------|--------------------|-------|-------------------------|---------------------------|
| | | DIAMETER | | WIDTH | | DEPTH | FREE DIAMETER | | THICKNESS | | SECTION | | RING Safety factor of 3 | GROOVE Safety factor of 2 |
| | | Dg | Tol. | W | Tol. | d | Df | Tol. | T | Tol. | S | Tol. | | |
| KM-587 | 5.875 | 6.028 | +.007 | .079 | +.005 | .077 | 6.077 | | .072 | | .250 | +.004 | 55810 | 31980 |
| KM-590 | 5.905 | 6.058 | -.007 | .079 | -.000 | .077 | 6.106 | +.045 | .072 | | .250 | -.006 | 56100 | 32140 |
| KM-600 | 6.000 | 6.153 | | .079 | | .077 | 6.202 | -.000 | .072 | | .250 | | 57000 | 32660 |
| KM-612 | 6.125 | 6.297 | | .094 | | .086 | 6.349 | | .086 | | .312 | | 69500 | 37200 |
| KM-625 | 6.250 | 6.422 | | .094 | | .086 | 6.474 | | .086 | | .312 | | 70920 | 37990 |
| KM-629 | 6.299 | 6.471 | | .094 | | .086 | 6.524 | | .086 | | .312 | | 71480 | 38290 |
| KM-637 | 6.375 | 6.547 | | .094 | | .086 | 6.601 | | .086 | | .312 | | 72340 | 38750 |
| KM-650 | 6.500 | 6.672 | | .094 | | .086 | 6.726 | | .086 | | .312 | | 73760 | 39510 |
| KM-662 | 6.625 | 6.807 | | .094 | | .091 | 6.863 | +.055 | .086 | | .312 | | 75180 | 42620 |
| KM-669 | 6.692 | 6.874 | | .094 | | .091 | 6.931 | -.000 | .086 | | .312 | | 75940 | 43050 |
| KM-675 | 6.750 | 6.932 | | .094 | | .091 | 6.987 | | .086 | | .312 | | 76600 | 43420 |
| KM-687 | 6.875 | 7.057 | | .094 | | .091 | 7.114 | | .086 | | .312 | | 78010 | 44220 |
| KM-700 | 7.000 | 7.182 | | .094 | | .091 | 7.239 | | .086 | | .312 | | 79430 | 45030 |
| KM-708 | 7.086 | 7.278 | | .094 | | .096 | 7.337 | | .086 | | .312 | | 80410 | 48080 |
| KM-712 | 7.125 | 7.317 | | .094 | | .096 | 7.376 | | .086 | | .312 | | 80850 | 48350 |
| KM-725 | 7.250 | 7.442 | | .094 | | .096 | 7.501 | | .086 | | .312 | | 82270 | 49200 |
| KM-737 | 7.375 | 7.567 | | .094 | | .096 | 7.628 | | .086 | | .312 | | 83690 | 50050 |
| KM-748 | 7.480 | 7.672 | | .094 | | .096 | 7.734 | | .086 | | .312 | +.004 | 84880 | 50760 |
| KM-750 | 7.500 | 7.692 | +.008 | .094 | +.006 | .096 | 7.754 | | .086 | | .312 | -.008 | 85110 | 50890 |
| KM-762 | 7.625 | 7.827 | -.008 | .094 | -.000 | .101 | 7.890 | | .086 | | .312 | | 86520 | 54440 |
| KM-775 | 7.750 | 7.952 | | .094 | | .101 | 8.014 | | .086 | +.004 | .312 | | 87940 | 55330 |
| KM-787 | 7.875 | 8.077 | | .094 | | .101 | 8.131 | | .086 | -.004 | .312 | | 89360 | 63360 |
| KM-800 | 8.000 | 8.202 | | .094 | | .101 | 8.266 | | .086 | | .312 | | 90780 | 57110 |
| KM-825 | 8.250 | 8.462 | | .094 | | .106 | 8.528 | | .086 | | .375 | | 93620 | 61820 |
| KM-826 | 8.267 | 8.479 | | .094 | | .106 | 8.546 | | .086 | | .375 | | 93810 | 61940 |
| KM-846 | 8.464 | 8.676 | | .094 | | .106 | 8.744 | +.065 | .086 | | .375 | | 96050 | 63420 |
| KM-850 | 8.500 | 8.712 | | .094 | | .106 | 8.780 | -.000 | .086 | | .375 | | 96450 | 63690 |
| KM-875 | 8.750 | 8.972 | | .094 | | .111 | 9.041 | | .086 | | .375 | | 99290 | 68650 |
| KM-885 | 8.858 | 9.080 | | .094 | | .111 | 9.151 | | .086 | | .375 | | 100520 | 69500 |
| KM-900 | 9.000 | 9.222 | | .094 | | .111 | 9.293 | | .086 | | .375 | | 102130 | 70620 |
| KM-905 | 9.055 | 9.287 | | .094 | | .116 | 9.359 | | .086 | | .375 | | 102750 | 74250 |
| KM-925 | 9.250 | 9.482 | | .094 | | .116 | 9.555 | | .086 | | .375 | | 104960 | 75850 |
| KM-944 | 9.448 | 9.680 | | .094 | | .116 | 9.755 | | .086 | | .375 | | 107210 | 77470 |
| KM-950 | 9.500 | 9.732 | | .094 | | .116 | 9.806 | | .086 | | .375 | | 107800 | 77900 |
| KM-975 | 9.750 | 9.992 | | .094 | | .121 | 10.068 | | .086 | | .375 | | 110640 | 83390 |
| KM-1000 | 10.000 | 10.242 | | .094 | | .121 | 10.320 | | .086 | | .375 | | 113470 | 85530 |
| KM-1025 | 10.250 | 10.502 | | .094 | | .126 | 10.582 | | .086 | | .375 | | 116310 | 91290 |
| KM-1050 | 10.500 | 10.752 | | .094 | | .126 | 10.834 | | .086 | | .375 | | 119150 | 93520 |
| KM-1075 | 10.750 | 11.012 | | .094 | | .131 | 11.095 | | .086 | | .375 | | 121990 | 99540 |
| KM-1100 | 11.000 | 11.262 | | .094 | | .131 | 11.347 | | .086 | | .375 | | 124820 | 101860 |