

Durchmesser im ungespannten Zustand und Ringabmessung mit Schnitt B-B

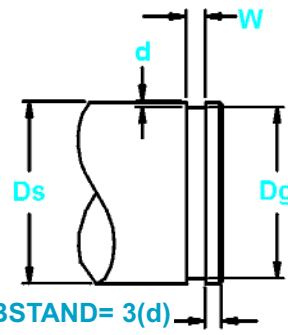

Wellendurchmesser und Nutabmessungen

Material: SAE 1060-1075

| RING GRÖßE | WELLENDURCHMESSER |          |       | NUTGRÖßE |          |       |          | RINGABMESSUNGEN |       |         |                |          |                                     | ZULÄSSIGE AXIAL-BELASTUNG (Lbs.) |       |
|------------|-------------------|----------|-------|----------|----------|-------|----------|-----------------|-------|---------|----------------|----------|-------------------------------------|----------------------------------|-------|
|            |                   |          |       |          |          |       |          | LICHTER DURCHM. |       | DICKE T | Radiale Breite |          | Spaltbreite im ungespannten Zustand |                                  |       |
|            | Dh DEZ            | Dh BRUCH | Dh mm | Dg       | TOL.     | W     | d        | Df              | TOL.  |         | ±.002          | S        | TOL.                                |                                  | A Min |
| USC-31     | .312              | 5/16     | 7.92  | .290     | +/- .002 | .028  | .011     | .281            | +.000 | .025    | .040           | +/- .003 | .031                                | .156                             | 180   |
| USC-34     | .344              | 11/32    | 8.74  | .322     |          |       | .011     | .312            |       | -.015   | .025           |          | .040                                | .031                             | .156  |
| USC-35     | .354              | -        | 8.99  | .330     |          |       | .012     | .320            | +.000 | .025    | .040           |          | .031                                | .156                             | 210   |
| USC-37     | .375              | 3/8      | 9.53  | .351     |          |       | .012     | .341            |       | -.020   | .025           |          | .040                                | .031                             | .156  |
| USC-39     | .393              | -        | 10.31 | .369     |          |       | .012     | .359            | +.000 | .025    | .040           |          | .031                                | .156                             | 260   |
| USC-40     | .406              | 13/32    | 11.13 | .382     |          |       | .012     | .372            |       | -.020   | .025           |          | .040                                | .031                             | .156  |
| USC-43     | .438              | 7/16     | 11.91 | .412     |          |       | .013     | .402            | +.000 | .025    | .040           |          | .031                                | .156                             | 300   |
| USC-46     | .469              | 15/32    | 12.70 | .443     |          |       | .013     | .433            |       | -.025   | .025           |          | .040                                | .031                             | .156  |
| USC-50     | .500              | 1/2      | 14.00 | .474     |          |       | .013     | .464            | +.000 | .035    | .048           |          | .062                                | .218                             | 460   |
| USC-55     | .551              | -        | 14.27 | .524     |          |       | .013     | .514            |       | -.025   | .035           |          | .048                                | .062                             | .218  |
| USC-56     | .562              | 9/16     | 15.09 | .534     | .014     | .524  | +.000    | .035            | .048  | .062    | .218           | 490      |                                     |                                  |       |
| USC-59     | .594              | 19/32    | 15.88 | .566     | .014     | .555  |          | -.025           | .035  | .062    | .062           | .218     | 510                                 |                                  |       |
| USC-62     | .625              | 5/8      | 17.00 | .597     | .014     | .586  | +.000    | .035            | .062  | .062    | .218           | 520      |                                     |                                  |       |
| USC-66     | .669              | -        | 17.00 | .640     | .015     | .630  |          | -.025           | .035  | .062    | .062           | .218     | 570                                 |                                  |       |
| USC-68     | .688              | 11/16    | 48.00 | .656     | .016     | .644  | +.000    | .042            | .062  | .062    | .218           | 700      |                                     |                                  |       |
| USC-75     | .750              | 3/4      | 19.05 | .716     | .017     | .703  |          | -.031           | .042  | .062    | .062           | .218     | 820                                 |                                  |       |
| USC-78     | .781              | 25/32    | 19.84 | .745     | .018     | .733  | +.000    | .042            | .062  | .062    | .218           | 950      |                                     |                                  |       |
| USC-81     | .812              | 13/16    | 20.62 | .776     | .018     | .764  |          | -.000           | .042  | .062    | .062           | .218     | 1010                                |                                  |       |
| USC-87     | .875              | 7/8      | 22.23 | .835     | .020     | .820  | +.000    | .042            | .078  | .093    | .250           | 1100     |                                     |                                  |       |
| USC-93     | .938              | 15/16    | 23.83 | .896     | .021     | .881  |          | -.000           | .042  | .078    | .093           | .250     | 1130                                |                                  |       |
| USC-98     | .984              | 63/64    | 25.00 | .940     | .022     | .925  | +/- .003 | .042            | .078  | .093    | .250           | 1170     |                                     |                                  |       |
| USC-100    | 1.000             | 1        | 25.40 | .956     | .022     | .941  |          | +.000           | .042  | .093    | .156           | .312     | 1200                                |                                  |       |
| USC-102    | 1.023             | -        | 25.98 | .977     | .023     | .962  | +.000    | .042            | .093  | .156    | .312           | 1300     |                                     |                                  |       |
| USC-106    | 1.062             | 1-1/16   | 26.97 | 1.016    | .023     | 1.000 |          | -.031           | .050  | .093    | .156           | .312     | 1600                                |                                  |       |
| USC-112    | 1.125             | 1-1/8    | 28.58 | 1.075    | .025     | 1.060 | +.000    | .050            | .093  | .156    | .312           | 1880     |                                     |                                  |       |
| USC-118    | 1.188             | 1-3/16   | 30.18 | 1.136    | .026     | 1.121 |          | -.000           | .050  | .093    | .156           | .312     | 1990                                |                                  |       |
| USC-125    | 1.250             | 1-1/4    | 31.75 | 1.194    | .028     | 1.179 | +.000    | .050            | .093  | .156    | .312           | 2090     |                                     |                                  |       |
| USC-131    | 1.312             | 1-5/16   | 33.32 | 1.25     | .031     | 1.232 |          | -.000           | .050  | .093    | .156           | .312     | 2100                                |                                  |       |
| USC-137    | 1.375             | 1-3/8    | 34.93 | 1.309    | .033     | 1.291 | +/- .004 | .050            | .109  | .156    | .312           | 2300     |                                     |                                  |       |
| USC-143    | 1.438             | 1-7/16   | 36.53 | 1.370    | .034     | 1.351 |          | +.000           | .050  | .109    | .156           | .312     | 2460                                |                                  |       |
| USC-150    | 1.500             | 1-1/2    | 38.10 | 1.430    | .035     | 1.408 | +/- .004 | .050            | .109  | .156    | .312           | 2500     |                                     |                                  |       |
| USC-156    | 1.562             | 1-9/16   | 39.67 | 1.490    | .036     | 1.467 |          | -.000           | .062  | .125    | .156           | .375     | 3060                                |                                  |       |
| USC-162    | 1.625             | 1-5/8    | 41.28 | 1.551    | .037     | 1.527 | +.000    | .062            | .125  | .156    | .375           | 3190     |                                     |                                  |       |
| USC-168    | 1.688             | 1-11/16  | 42.90 | 1.611    | .038     | 1.581 |          | -.000           | .062  | .125    | .156           | .375     | 3370                                |                                  |       |
| USC-175    | 1.750             | 1-3/4    | 44.40 | 1.670    | .04      | 1.640 | +.004    | .062            | .125  | .156    | .375           | 3510     |                                     |                                  |       |
| USC-177    | 1.772             | -        | 45.00 | 1.687    | .042     | 1.657 |          | -.000           | .062  | .141    | .156           | .375     | 3550                                |                                  |       |
| USC-181    | 1.812             | 1-13/16  | 46.00 | 1.728    | .042     | 1.698 | +.004    | .062            | .141  | .156    | .375           | 3640     |                                     |                                  |       |
| USC-187    | 1.875             | 1-7/8    | 47.60 | 1.789    | .043     | 1.759 |          | -.000           | .062  | .156    | .156           | .375     | 3760                                |                                  |       |
| USC-196    | 1.969             | 1-31/32  | 50.00 | 1.879    | .045     | 1.849 | +.000    | .062            | .156  | .156    | .375           | 3940     |                                     |                                  |       |
| USC-200    | 2.000             | 2        | 50.80 | 1.910    | .045     | 1.880 |          | -.046           | .062  | .156    | .156           | .375     | 4010                                |                                  |       |
| USC-206    | 2.062             | 2-1/16   | 52.40 | 1.966    | .048     | 1.936 | +.000    | .078            | .156  | .156    | .375           | 5350     |                                     |                                  |       |
| USC-212    | 2.125             | 2-1/8    | 54.00 | 2.027    | .049     | 1.997 |          | -.000           | .078  | .156    | .156           | .375     | 5470                                |                                  |       |
| USC-215    | 2.156             | 2-5/32   | 54.80 | 2.056    | .050     | 2.026 | +/- .006 | .078            | .156  | .156    | .375           | 5680     |                                     |                                  |       |
| USC-225    | 2.250             | 2-1/4    | 57.10 | 2.146    | .052     | 2.116 |          | +.005           | .078  | .156    | .156           | .375     | 5790                                |                                  |       |
| USC-231    | 2.312             | 2-5/16   | 58.70 | 2.204    | .054     | 2.174 | +.005    | .078            | .187  | .156    | .375           | 6300     |                                     |                                  |       |
| USC-237    | 2.375             | 2-3/8    | 60.30 | 2.265    | .055     | 2.235 |          | -.000           | .078  | .187    | .156           | .375     | 6400                                |                                  |       |
| USC-243    | 2.438             | 2-7/16   | 61.90 | 2.325    | .056     | 2.295 | +.005    | .078            | .187  | .156    | .375           | 6500     |                                     |                                  |       |
| USC-250    | 2.500             | 2-1/2    | 63.50 | 2.386    | .057     | 2.356 |          | -.000           | .078  | .187    | .156           | .375     | 6600                                |                                  |       |
| USC-255    | 2.559             | -        | 65.00 | 2.443    | .058     | 2.413 | +.000    | .078            | .187  | .156    | .375           | 6700     |                                     |                                  |       |

Für alternative Ausführungen der Ringenden wenden Sie sich bitte an unseren technischen Verkauf unter:rcgmbh@rotorclip.com

# Für Wellen, zur Sicherung von Nadellagern

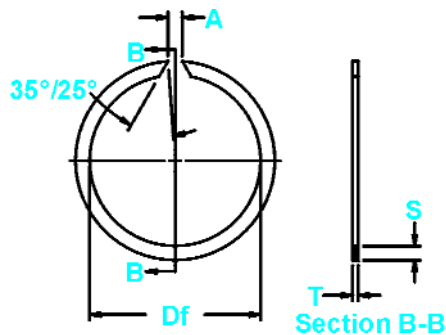

Durchmesser im ungespannten Zustand und Ringabmessung mit Schnitt B-B

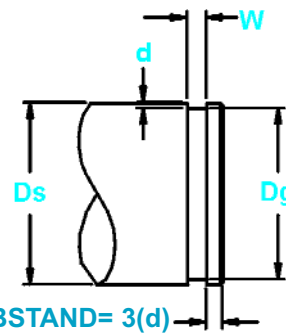

KANTENABSTAND= 3(d)

Wellendurchmesser und Nutabmessungen

Material: SAE 1060-1075

| RING GRÖßE | WELLENDURCHMESSER |          |       | NUTGRÖßE    |          |            | RINGABMESSUNGEN |                 |       |       | Spaltbreite im ungespannten Zustand |          | ZULÄSSIGE AXIAL-BELASTUNG (Lbs.) |                |       |
|------------|-------------------|----------|-------|-------------|----------|------------|-----------------|-----------------|-------|-------|-------------------------------------|----------|----------------------------------|----------------|-------|
|            |                   |          |       | DURCHMESSER |          | BREITE     | TIEFE           | LICHTER DURCHM. |       | DICKE |                                     |          |                                  | Radiale Breite |       |
|            | Dh DEZ            | Dh BRUCH | Dh mm | Dg          | TOL.     | W          | d               | Df              | TOL.  | ±.002 | S                                   | TOL.     |                                  | A Min          | A Max |
| USC-262    | 2.625             | 2-5/8    | 66.70 | 2.505       |          | .086       | .060            | 2.475           | +.000 | .078  | .187                                |          | .156                             | .375           | 6800  |
| USC-268    | 2.688             | 2-11/16  | 68.30 | 2.565       |          | +.005-.000 | .061            | 2.535           | -.046 | .078  | .187                                |          | .156                             | .375           | 6900  |
| USC-275    | 2.750             | 2-3/4    | 69.80 | 2.624       |          |            | .063            | 2.594           |       | .093  | .187                                |          | .187                             | .437           | 8460  |
| USC-287    | 2.875             | 2-7/8    | 73.00 | 2.743       |          |            | .066            | 2.713           |       | .093  | .187                                |          | .187                             | .437           | 8840  |
| USC-293    | 2.938             | 2-15/16  | 74.60 | 2.801       |          |            | .068            | 2.771           |       | .093  | .187                                |          | .187                             | .437           | 9030  |
| USC-300    | 3.000             | 3        | 76.20 | 2.860       |          |            | .070            | 2.830           | +.000 | .093  | .218                                |          | .187                             | .437           | 9230  |
| USC-306    | 3.062             | 3-1/16   | 77.80 | 2.920       |          |            | .071            | 2.890           | -.062 | .093  | .218                                |          | .187                             | .437           | 9420  |
| USC-312    | 3.125             | 3-1/8    | 79.40 | 2.981       |          |            | .072            | 2.951           |       | .093  | .218                                |          | .187                             | .437           | 9630  |
| USC-315    | 3.156             | 3-5/32   | 80.20 | 3.010       |          |            | .073            | 2.980           |       | .093  | .218                                |          | .187                             | .437           | 9800  |
| USC-325    | 3.250             | 3-1/4    | 82.50 | 3.100       |          |            | .075            | 3.070           |       | .093  | .250                                |          | .187                             | .437           | 10000 |
| USC-334    | 3.346             | 3-11/32  | 85.00 | 3.190       |          |            | .077            | 3.160           |       | .093  | .250                                |          | .187                             | .437           | 10290 |
| USC-343    | 3.438             | 3-7/16   | 87.3  | 3.281       |          |            | .078            | 3.251           |       | .093  | .250                                |          | .187                             | .437           | 10570 |
| USC-350    | 3.500             | 3-1/2    | 88.9  | 3.340       | +/- .006 |            | .080            | 3.305           |       | .109  | .250                                |          | .250                             | .562           | 11970 |
| USC-354    | 3.543             | -        | 90.0  | 3.381       |          |            | .081            | 3.346           |       | .109  | .250                                |          | .250                             | .562           | 12120 |
| USC-362    | 3.625             | 3-5/8    | 92.1  | 3.458       |          |            | .083            | 3.423           | +.000 | .109  | .250                                |          | .250                             | .562           | 12300 |
| USC-368    | 3.688             | 3-11/16  | 93.7  | 3.517       |          |            | .085            | 3.482           | -.078 | .109  | .250                                |          | .250                             | .562           | 12600 |
| USC-375    | 3.750             | 3-3/4    | 95.2  | 3.576       |          |            | .087            | 3.541           |       | .109  | .250                                |          | .250                             | .562           | 12800 |
| USC-387    | 3.875             | 3-7/8    | 98.4  | 3.697       |          |            | .089            | 3.657           |       | .109  | .281                                |          | .250                             | .562           | 13200 |
| USC-393    | 3.938             | 3-15/16  | 100.0 | 3.758       |          |            | .090            | 3.713           |       | .109  | .281                                |          | .250                             | .562           | 13470 |
| USC-400    | 4.000             | 4        | 101.6 | 3.816       |          |            | .092            | 3.771           |       | .109  | .281                                | +/- .005 | .250                             | .656           | 13650 |
| USC-425    | 4.250             | 4-1/4    | 108.0 | 4.066       |          |            | .092            | 4.016           |       | .109  | .281                                |          | .250                             | .656           | 15000 |
| USC-437    | 4.375             | 4-3/8    | 111.1 | 4.191       |          |            | .092            | 4.141           | +.000 | .109  | .281                                |          | .250                             | .656           | 15500 |
| USC-450    | 4.500             | 4 1/2    | 114.3 | 4.310       |          |            | .095            | 4.255           | -.093 | .109  | .312                                |          | .250                             | .656           | 16200 |
| USC-475    | 4.750             | 4-3/4    | 120.6 | 4.550       |          |            | .100            | 4.495           |       | .109  | .312                                |          | .250                             | .656           | 16480 |
| USC-500    | 5.000             | 5        | 127.0 | 4.790       |          |            | .105            | 4.730           |       | .109  | .312                                |          | .250                             | .656           | 17110 |
| USC-525    | 5.250             | 5-1/4    | 133.3 | 5.030       |          |            | .110            | 4.970           |       | .125  | .375                                |          | .250                             | .750           | 20590 |
| USC-550    | 5.500             | 5-1/2    | 139.7 | 5.266       |          |            | .117            | 5.206           |       | .125  | .375                                |          | .250                             | .750           | 21790 |
| USC-575    | 5.750             | 5-3/4    | 146.0 | 5.506       |          |            | .122            | 5.446           |       | .125  | .375                                |          | .250                             | .750           | 23010 |
| USC-590    | 5.900             | -        | 149.9 | 5.656       |          |            | .122            | 5.600           |       | .125  | .375                                |          | .250                             | .750           | 23625 |
| USC-600    | 6.000             | 6        | 152.4 | 5.746       |          |            | .127            | 5.687           |       | .125  | .375                                |          | .250                             | .750           | 24000 |
| USC-625    | 6.250             | 6-1/4    | 158.7 | 5.986       |          |            | .132            | 5.916           |       | .156  | .437                                |          | .250                             | .750           | 30310 |
| USC-650    | 6.500             | 6-1/2    | 165.1 | 6.226       |          |            | .137            | 6.151           | +.000 | .156  | .437                                |          | .250                             | .750           | 33760 |
| USC-675    | 6.750             | 6-3/4    | 171.4 | 6.466       |          |            | .142            | 6.386           | -.125 | .156  | .437                                |          | .250                             | .750           | 36840 |
| USC-700    | 7.000             | 7        | 177.8 | 6.706       |          |            | .147            | 6.621           |       | .156  | .437                                |          | .250                             | .750           | 39920 |
| USC-725    | 7.250             | 7-1/4    | 184.2 | 6.930       |          |            | .160            | 6.840           |       | .187  | .500                                |          | .250                             | .875           | 43100 |
| USC-750    | 7.500             | 7-1/2    | 190.5 | 7.180       | +/- .008 |            | .160            | 7.090           |       | .187  | .500                                |          | .250                             | .875           | 44500 |
| USC-800    | 8.000             | 8        | 203.2 | 7.660       |          |            | .170            | 7.560           |       | .187  | .500                                |          | .250                             | .875           | 45500 |
| USC-850    | 8.500             | 8-1/2    | 215.9 | 8.160       |          |            | .170            | 8.050           | +.000 | .187  | .500                                |          | .250                             | .875           | 46700 |
| USC-900    | 9.000             | 9        | 228.6 | 8.660       |          |            | .170            | 8.545           | -.156 | .187  | .500                                |          | .250                             | .875           | 49900 |
| USC-925    | 9.250             | 9-1/4    | 234.9 | 8.910       |          |            | .170            | 8.800           |       | .187  | .500                                |          | .250                             | .875           | 51000 |
| USC-950    | 9.500             | 9-1/2    | 241.3 | 9.160       |          |            | .170            | 9.040           |       | .187  | .500                                |          | .250                             | .875           | 52590 |
| USC-1000   | 10.000            | 10       | 254.0 | 9.660       |          |            | .170            | 9.535           |       | .187  | .500                                |          | .250                             | .875           | 55600 |

|  |           |       |
|--|-----------|-------|
| Material: SAE 1060/1075 Kohlenstoff-Federstahl |           |       |
| Härte  | Ringgröße | HRC   |
|  | 137-700   | 42-53 |
|  | 725-1000  | 40-47 |

\*In der Nut montiert.  
 BEMERKUNG: ROTOR CLIP KANN JEDLICHE RINGGRÖßE FÜR SIE HERSTELLEN.  
 WENDEN SIE SICH BITTE AN UNSEREN TECHNISCHEN VERKAUF UNTER [rcgmbh@rotorclip.com](mailto:rcgmbh@rotorclip.com).