

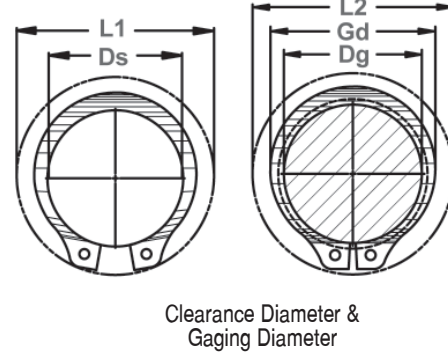

BSH Shaft Rings

Axially Assembled, External Bowed
 Compensating for accumulated tolerances is what a BSH "bowed" retaining ring is designed to do on a shaft. Once snapped into the groove, bowed rings exert a force or a "preload" on the retained parts for the range specified.

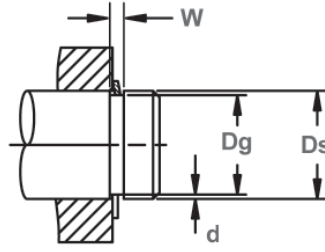
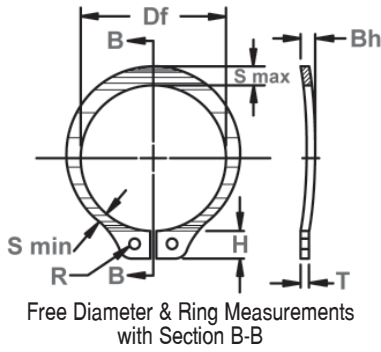

RING NO.	SHAFT DIAMETER			GROOVE SIZE			RING SIZE & WEIGHT					CLEAR. DIA.			THRUST LD. (lbs.)					
				Dg	DIAMETER		W	DEPTH	FREE DIAMETER		THICKNESS ***		BOW HEIGHT	Wght. Per 1000 Pcs.	Ex-panded over shaft	Re-leased in groove	Sqr. Corner Abutment	GROOVE Safety Factor of 2		
	Tol.	Tol.	d		Df	Tol.			Tol.	Bh	Tol.	Pr					Pg			
BSH-25	.250	1/4	6.4	.230	±.0015	.040	.10	.225	+ .002	.025	.047	.21	.45	.43	599	175				
BSH-27	.276	-	7.0	.255	±.002	.040	.10	.250	+ .002	.025	.047	.23	.48	.46	660	195				
BSH-28	.281	9/32	7.1	.261		.040	.10	.256		.025	.047	.24	.49	.47	670	200				
BSH-31	.312	5/16	7.9	.290		.040	.11	.281		.025	.047	.27	.54	.52	751	240				
BSH-34	.344	11/32	8.7	.321		.040	.11	.309		.025	.047	.31	.57	.55	812	265				
BSH-35	.354	-	9.0	.330		.040	.12	.320		.025	.047	.35	.59	.57	832	300				
BSH-37	.375	3/8	9.5	.352		.040	.12	.338		.025	.047	.39	.61	.59	883	325				
BSH-39	.394	-	10.0	.369		.040	.12	.354		.025	.047	.42	.62	.60	954	335				
BSH-40	.406	13/32	10.3	.382		.040	.12	.366		.025	.047	.43	.63	.61	964	350				
BSH-43	.438	7/16	11.1	.412		.040	.13	.395		.025	.047	.50	.66	.64	1035	400				
BSH-46	.469	15/32	11.9	.443		.040	.13	.428		.025	.047	.54	.68	.66	1117	450				
BSH-50	.500	1/2	12.7	.468	±.002	.055	.16	.461	±.002	.035	.063	.91	.77	.74	1675	550				
BSH-55	.551	-	14.0	.519	±.004*	.055	.16	.509		.035	.063	.90	.81	.78	1827	600				
BSH-56	.562	9/16	14.3	.530	.055	.16	.521	.035		.063	1.1	.82	.79	1878	650					
BSH-59	.594	19/32	15.1	.559	.055	.17	.550	.035		.063	1.2	.86	.83	1979	750					
BSH-62	.625	5/8	15.9	.588	.055	.18	.579	.035		.063	1.3	.90	.87	2091	800					
BSH-66	.669	-	17.0	.629	±.003	.055	.20	.621		±.002	.035	.063	1.4	.93	.89	2233	950			
BSH-66	.672	43/64	17.1	.631		.055	.20	.621			.035	.063	1.4	.93	.89	2233	950			
BSH-68	.688	11/16	17.5	.646		.062	.21	.635			.042	.073	1.8	1.01	.97	3451	1000			
BSH-75	.750	3/4	19.0	.704		.062	.23	.693			.042	.073	2.1	1.09	1.05	3756	1200			
BSH-78	.781	25/32	19.8	.733		.062	.24	.722			.042	.073	2.2	1.12	1.08	3959	1300			
BSH-81	.812	13/16	20.6	.762		.062	.25	.751	.042		.073	2.5	1.15	1.10	4060	1450				
BSH-87	.875	7/8	22.2	.821		.062	.27	.810	.042		.073	2.8	1.21	1.16	4365	1650				
BSH-93	.938	15/16	23.8	.882		.062	.28	.867	.042		.073	3.1	1.34	1.29	4720	1850				
BSH-98	.984	63/64	25.0	.926		.062	.29	.910	.042		.073	3.5	1.39	1.34	4923	2000				
BSH-100	1.000	1	25.4	.940		.062	.30	.925	.042		.073	3.6	1.41	1.35	5024	2100				
BSH-102	1.023	-	26.0	.961	.062	.31	.946	.042	.073	3.9	1.43	1.37	5126	2250						
BSH-106	1.062	1-1/16	27.0	.998	.070	.32	.982	.050	.085	4.8	1.50	1.44	6293	2400						
BSH-112	1.125	1-1/8	28.6	1.059	.070	.33	1.041	.050	.085	5.1	1.55	1.49	6699	2600						
BSH-118	1.188	1-3/16	30.2	1.118	.070	.35	1.098	.050	.085	5.6	1.61	1.54	7105	2950						
BSH-125	1.250	1-1/4	31.7	1.176	±.004	.070	.37	1.156	+ .010	.050	.085	5.9	1.69	1.62	7460	3250				
BSH-131	1.312	1-5/16	33.3	1.232		.070	.40	1.214		.050	.085	6.8	1.75	1.67	7866	3700				
BSH-137	1.375	1-3/8	34.9	1.291		.070	.42	1.272		.050	.085	7.2	1.80	1.72	8222	4100				
BSH-143	1.438	1-7/16	36.5	1.350		.070	.44	1.333		.050	.085	8.1	1.87	1.79	8628	4500				
BSH-150	1.500	1-1/2	38.1	1.406		.070	.47	1.387		.050	.085	9.0	1.99	1.90	8932	5000				
BSH-162	1.625	1-5/8	41.3	1.529		±.005	.096	.48		1.503	+ .013	.062	±.003	.115	±.015	13.2	2.17	2.08	12028	5500
BSH-175	1.750	1-3/4	44.4	1.650		±.005*	.096	.50		1.618		.062	.115	15.3	2.31	2.21	12992	6200		

*F.I.M. (FULL INDICATOR MOVEMENT)-MAXIMUM ALLOWABLE DEVIATION OF CONCENTRICITY BETWEEN GROOVE AND SHAFT.

† BASED ON HOUSINGS/SHAFTS MADE OF COLD ROLLED STEEL. FOR AN EXPLANATION OF FORMULAS USED TO DERIVE THRUST LOAD AND OTHER PERFORMANCE DATA, CONTACT THE ROTOR CLIP ENGINEERING DEPT.

***FOR PLATED RINGS, ADD .002" TO THE LISTED MAXIMUM THICKNESS.

HARDNESS RANGES: STAINLESS STEEL RINGS (PH 15-7MO)

RING TYPE	SIZE RANGE	SCALE	ROCKWELL HARDNESS
BSH	25-81	30N	63-69.5
	87+	C	44-51



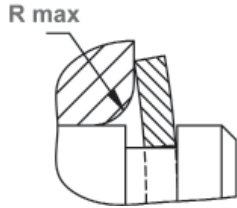

Maximum Corner Radius & Chamfer

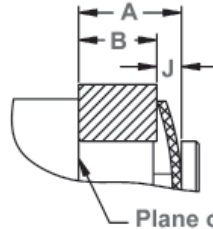
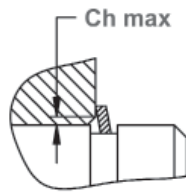

Outer Groove Location
 $A \text{ max} = B \text{ min} + J \text{ max}$
 $A \text{ min} = B \text{ max} + J \text{ min}$

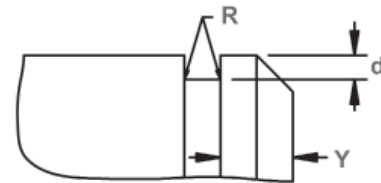

Exploded Groove Profile & Edge Margin (Y) Maximum bottom radii (R), square corners For ring sizes -25 thru -35; .005 For ring sizes -37 thru -100; .010 For ring sizes -102 and over.

RING NO.	DISTANCE Outer groove wall to face of retained part		TAKE-UP Resilient take-up of tolerances J max J min	FORCE Needed to flatten rings lbs.	ALLOWABLE CORNER RADII & CHAMFERS		MAX. LOAD w/ R max or Ch max (in lbs.) P _r (lbs.)	EDGE MARGIN Y	LUG HEIGHT H Tol.	MAXIMUM SECTION		MINIMUM SECTION		HOLE DIAMETER		GAGING DIA. Gd Max	R.P.M LIMITS Standard material	
	J min	J max			R max	Ch max				S max	Tol.	S min	Tol.	R	Tol.			
BSH-25	.030	.038	.008	50	.018	.011	470	.030	.080	±.003	.035	±.003	.025	±.003	.041	+.010 -.002	.290	80000
BSH-27	.030	.038		50	.0175	.0105	470	.031	.081		.035		.024		.041		.315	76000
BSH-28	.030	.038		50	.020	.012	470	.030	.080		.038		.0255		.041		.326	74000
BSH-31	.030	.038		50	.020	.012	470	.033	.087		.040		.026		.041		.357	70000
BSH-34	.030	.038		45	.021	.0125	470	.033	.087		.042		.0265		.041		.390	64000
BSH-35	.030	.038		45	.023	.014	470	.036	.087		.046		.029		.041		.405	62000
BSH-37	.030	.038		45	.026	.0155	470	.036	.088		.050		.0305		.041		.433	60000
BSH-39	.030	.038		40	.027	.016	470	.037	.087		.052		.031		.041		.452	56500
BSH-40	.030	.038		40	.0285	.017	470	.036	.087		.054		.033		.041		.468	55000
BSH-43	.030	.038		35	.029	.0175	470	.039	.088		.055		.033		.041		.501	50000
BSH-46	.030	.038	35	.031	.018	470	.039	.088	.060	.035	.041	.540	42000					
BSH-50	.042	.053	.011	90	.034	.020	910	.048	.108	±.004	.065	±.004	.040	±.005	.047	+.015 -.002	.574	40000
BSH-55	.042	.053		85	.027	.0165	910	.048	.108		.053		.036		.047		.611	36000
BSH-56	.042	.053		80	.038	.023	910	.048	.108		.072		.041		.047		.644	35000
BSH-59	.042	.053		70	.0395	.0235	910	.052	.109		.076		.043		.047		.680	32000
BSH-62	.042	.053		60	.0415	.025	910	.055	.110		.080		.045		.047		.715	30000
BSH-66	.042	.053		50	.040	.024	910	.060	.110		.082		.043		.047		.756	29000
BSH-66	.042	.053		50	.040	.024	910	.060	.110		.082		.043		.047		.758	29000
BSH-68	.049	.060		70	.042	.025	1340	.063	.136		.084		.048		.052		.779	28000
BSH-75	.049	.060		65	.046	.0275	1340	.069	.136		.092		.051		.052		.850	26500
BSH-78	.049	.060		60	.047	.028	1340	.072	.136		.094		.052		.052		.883	25500
BSH-81	.049	.060	55	.047	.028	1340	.075	.136	.096	.054	.052	.914	24500					
BSH-87	.049	.060	45	.051	.035	1340	.081	.137	.104	.057	.052	.987	23000					
BSH-93	.049	.060	40	.055	.033	1340	.084	.166	.110	.063	.078	1.054	21500					
BSH-98	.049	.060	40	.056	.0335	1340	.087	.167	.114	.0645	.078	1.106	20500					
BSH-100	.049	.060	35	.057	.034	1340	.090	.167	.116	.065	.078	1.122	20000					
BSH-102	.049	.060	35	.058	.035	1340	.093	.168	.118	.066	.078	1.147	19500					
BSH-106	.057	.068	60	.060	.036	1950	.096	.181	.122	.069	.078	1.192	19000					
BSH-112	.057	.068	55	.063	.038	1950	.099	.182	.128	.071	.078	1.261	18800					
BSH-118	.057	.068	50	.064	.0385	1950	.105	.182	.132	.072	.078	1.325	18000					
BSH-125	.057	.068	45	.068	.041	1950	.111	.183	.140	.076	.078	1.396	17000					
BSH-131	.057	.068	40	.068	.041	1950	.120	.183	.146	.0765	.078	1.458	16500					
BSH-137	.057	.068	35	.072	.043	1950	.126	.184	.152	.082	.078	1.529	16000					
BSH-143	.057	.068	30	.076	.045	1950	.132	.184	.160	.086	.078	1.600	15000					
BSH-150	.057	.068	30	.079	.047	1950	.141	.214	.168	.091	.120	1.668	14800					
BSH-162	.069	.094	.025	55	.087	.052	3000	.144	.235	.180	.097	.125	1.812	13200				
BSH-175	.069	.094		50	.091	.054	3000	.150	.237	.188	.101	.125	1.945	12200				

LARGER SIZES MAY BE AVAILABLE UPON REQUEST.

HARDNESS RANGES: CARBON STEEL RINGS (SAE 1060-1090)

RING TYPE	SIZE RANGE	SCALE	ROCKWELL HARDNESS
BSH	25-46	30N	69.5-73
	50-81	30N	66-71
	87-102	C	47-53
	106+	C	47-52

HARDNESS RANGES: BERYLLIUM COPPER RINGS

RING TYPE	SIZE RANGE	SCALE	ROCKWELL HARDNESS
BSH	18-23	15N	77-82*
	25-102	30N	54-62
	106+	C	34-43

*HARDNESS CAN NOT BE CHECKED WITH ANY DEGREE OF ACCURACY DIRECTLY ON THESE RINGS.

