

Snap Ring, Internal, Inch

Designed for needle bearings, once installed in the groove of a housing/bore, the portion of the ring protruding from the groove holds an assembly in place.

HN Constant Section Rings

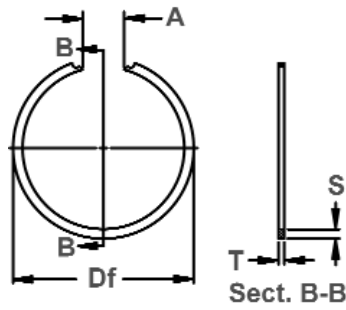

Free Diameter & Ring Measurement with Section B-B

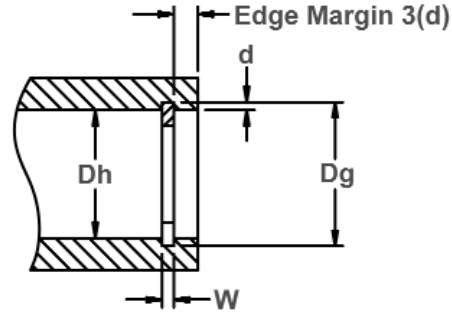

Housing Diameter & Groove Dimensions

Material SAE 1060-1075

RING SIZE	HOUSING DIAMETER			GROOVE SIZE			RING DIMENSIONS					ALLOWABLE STATIC THRUST LOAD (Lbs.)					
				DIAMETER		WIDTH	DEPTH	FREE DIAMETER		THICKNESS	SECTION		FREE GAP				
	Dh DEC	Dh FRACT.	Dh mm	Dg	TOL.	W	d	Df	TOL.	T ±.002	S		TOL.	A Min	A Max		
HN-112	1.125	1-1/8	28.58	1.181	±.005	.046 +.003 -.000	.028	1.196	+.031	.042	.093	±.003	.375	.562	1100		
HN-125	1.250	1-1/4	31.75	1.310			.030	1.330		.042	.093						
HN-137	1.375	1-3/8	34.93	1.435			.030	1.460		.042	.093						
HN-150	1.500	1-1/2	38.10	1.580			.040	1.600	.042	.125	+.062		.125	±.005	.375	.562	1900
HN-162	1.625	1-5/8	41.28	1.705			.040	1.725	.042	.125							
HN-175	1.750	1-3/4	44.45	1.830			.040	1.855	.042	.125							
HN-187	1.875	1-7/8	47.63	1.965			.045	1.990	.042	.156							
HN-200	2.000	2	50.80	2.090			.045	2.115	.042	.156							
HN-206	2.062	2-1/16	52.37	2.152			.045	2.177	.042	.156							
HN-218	2.187	2-3/16	55.55	2.277			.045	2.302	.042	.156							
HN-231	2.312	2-5/16	58.72	2.402	.045	2.432	.042	.156									
HN-243	2.437	2-7/16	61.90	2.527	.045	2.557	.042	.156									
HN-256	2.562	2-9/16	65.07	2.652	.045	2.682	.042	.156									
HN-300	3.000	3	76.20	3.124	±.006	.068 +.004 -.000	.062	3.154	+.078	.062	.187	±.005	.562	.938	6250		
HN-325	3.250	3-1/4	82.55	3.374			.062	3.404		.062	.187						
HN-350	3.500	3-1/2	88.90	3.624			.062	3.654		.062	.187						
HN-375	3.750	3-3/4	95.25	3.874			.062	3.904	.062	.187							
HN-400	4.000	4	101.60	4.125			.062	4.155	.062	.187							
HN-425	4.250	4-1/4	107.95	4.394			.072	4.429	.078	.218	+.093		.218	±.007	.625	1.062	9100
HN-450	4.500	4-1/2	114.30	4.644			.072	4.679	.078	.218							
HN-475	4.750	4-3/4	120.65	4.894			.072	4.929	.078	.218							
HN-500	5.000	5	127.00	5.144			.072	5.184	.078	.218							
HN-525	5.250	5-1/4	133.35	5.394			.072	5.434	.078	.218							
HN-575	5.750	5-3/4	146.05	5.894	.072	5.934	.078	.218									
HN-600	6.000	6	152.40	6.160	.080	6.220	.093	.250	+.125	.250		±.008	.875		1.437	9000	
HN-650	6.500	6-1/2	165.10	6.660	.080	6.730	.093	.250									
HN-700	7.000	7	177.80	7.160	.080	7.240	.093	.250									
HN-725	7.250	7-1/4	184.15	7.410	.080	7.500	.093	.250									
HN-750	7.500	7-1/2	190.50	7.660	.080	7.760	.093	.250									
HN-800	8.000	8	203.20	8.160	.080	8.285	.093	.250									

Hardness: All Ring Sizes-HRC 42-52

For alternate cutoff styles, contact Rotor Clip Technical Sales at 1-800-557-6867 (E-mail: tech@rotorclip.com)



For the most up-to-date specifications, online ordering, quotations & sample orders, visit www.rotorclip.com